

Vigo County, IN / City of Terre Haute

Summary - Assessor's Office

Parcel ID	84-09-10-102-010.000-004
Tax ID	84-09-10-102-010.000-004
Section Plat	10
Routing Number	
Neighborhood	102511 - HONEY CREEK
Property Address	4109 S 9th St Terre Haute, IN 47802
Legal Description	MARYLAND SUB (4109 S 9TH ST) AFF-2005008149 DC-124 D-400/114 10-11-9 LOT 203 (Note: Not to be used on legal documents)
Acreage	0.43
Class	510 - Res 1 fam dwelling platted lot
Tax District/Area	004 - HONEY CREEK

[View Map](#)



Owner - Auditor's Office

Deeded Owner
Pickens Todd W
4109 S 9th St
Terre Haute, IN 47802

Site Description - Assessor's Office

Topography	Level
Public Utilities	
Street or Road	Unpaved
Neigh. Life Cycle	Static
Legal Acres	0.43
Legal Sq Ft	0

Taxing Rate

2.6457

Land - Assessor's Office

Land Type	Soil ID	Actual Front	Acreage	Effect. Front	Effect. Depth	Prod Factor	Depth Factor	Meas Sq Ft	Base Rate	Adj Rate	Extended Value	Influ. Factor	Value
HOMESITE			0.430			1.00	1.60		23,545.00	37,672.00	16,200.00		16,200.00

Land Detail Value Sum 16,200.00

Residential Dwellings - Assessor's Office

Card 01			
Residential Dwelling 1			
Occupancy			
Story Height	1.0		
Roofing	Material: Asphalt shingles		
Attic	None		
Basement Type	None		
Basement Rec Room	None		
Finished Rooms	4		
Bedrooms	2		
Family Rooms	0		
Dining Rooms	0		
Full Baths	1; 3-Fixt.		
Half Baths	0; 0-Fixt.		
4 Fixture Baths	0; 0-Fixt.		
5 Fixture Baths	0; 0-Fixt.		
Kitchen Sinks	1; 1-Fixt.		
Water Heaters	1; 1-Fixt.		
Central Air	Yes		
Primary Heat	Central Warm Air		
Extra Fixtures	0		
Total Fixtures	5		
Fireplace	No		
Features	None		
Porches and Decks	Masonry Stoop 35		
	Roof Extension Canopy 35		
	CONCP 140		
Yd Item/Spc Fture/Outbldg	WOOD FRAME 414 SF		
	WOOD FRAME UTILITY SHED 200 SF		
Last Updated	2/3/2003		
Construction	Floor	Base Area	
Wood frame	1.0		
	Crawl		
	Total		

Improvements - Assessor's Office

Card 01

ID	Use	Stry Hgt	Const Type	Grade	Year Const	Eff Year	Cond	Base Rate	Features	Adj Rate	Size/ Area	Cost Value	Phys Depr	Obsol Depr	Mrkt Adj	% Comp	Value
D	DWELL	1		C-1	1963	1963	AV	0.00		0	1164	96150	42	0	138	100	77000
G01	ATTGAR		WOOD FRAME		0	0	AV	33.07		33.07	18 x 23	13690	0	0	100	100	0
01	UTLSHED		WOOD FRAME	D	2017	2017	AV	20.44		14.55	10 x 20	2910	25	0	138	100	3000

Transfer History - Assessor's Office

Date	Grantor	Grantee	Document #	Deed-Transaction Type	Transfer Type	Amount	Adjusted Sale Price
11/29/2018	PICKENS RUTH A	PICKENS TODD W	2018012617	Wa	S	\$75,000	\$75,000
5/17/2005	PICKENS LARRY W & RUTH A	PICKENS RUTH A	2005008149		S	\$0	\$0

Transfer Recording - Auditor's Office

Date	From	To	Instrument	Doc #
11/29/2018	PICKENS RUTH A	PICKENS TODD W	Warranty Deed	2018012617

Valuation - Assessor's Office

Assessment Year		01/01/2024	01/01/2023	01/01/2022	01/01/2021	01/01/2020
Reason for Change		ANN ADJ	ANN ADJ	ANN ADJ	ANN ADJ	ANN ADJ
VALUATION	Land	\$16,200	\$16,200	\$16,200	\$15,900	\$15,700
(Assessed Value)	Improvements	\$90,000	\$78,300	\$68,300	\$62,500	\$61,900
	Total	\$96,200	\$94,500	\$84,500	\$78,400	\$77,600
VALUATION	Land	\$16,200	\$16,200	\$16,200	\$15,900	\$15,700
(True Tax Value)	Improvements	\$80,000	\$78,300	\$68,300	\$62,500	\$61,900
	Total	\$96,200	\$94,500	\$84,500	\$78,400	\$77,600

Deductions - Auditor's Office

Type	Description	2023 Pay 2024	2022 Pay 2023	2021 Pay 2022	2020 Pay 2021	2019 Pay 2020	2018 Pay 2019
Homestead	Homestead Credit	\$48,000.00	\$45,000.00	\$45,000.00	\$45,000.00	\$44,220.00	\$43,020.00
Homestead	Supplemental HSC	\$17,400.00	\$12,915.00	\$10,815.00	\$10,535.00	\$10,318.00	\$10,038.00

Charges (2020-2024) - Auditor's Office

Delinquent payments made after the fall due date will still show due in the year they were originally assessed. If paid, payment will show in the next tax year.

	2023 Pay 2024	2022 Pay 2023	2021 Pay 2022	2020 Pay 2021	2019 Pay 2020
+ Spring Tax	\$384.95	\$295.56	\$255.28	\$234.49	\$232.71
+ Spring Penalty	\$0.00	\$0.00	\$0.00	\$0.00	\$0.00
+ Spring Annual	\$0.00	\$0.00	\$0.00	\$0.00	\$0.00
+ Fall Tax	\$384.95	\$295.56	\$255.28	\$234.49	\$232.71
+ Fall Penalty	\$0.00	\$0.00	\$0.00	\$0.00	\$0.00
+ Fall Annual	\$0.00	\$0.00	\$0.00	\$0.00	\$0.00
+ Delq NTS Tax	\$0.00	\$0.00	\$0.00	\$0.00	\$0.00
+ Delq NTS Pen	\$0.00	\$0.00	\$0.00	\$0.00	\$0.00
+ Delq TS Tax	\$0.00	\$0.00	\$0.00	\$0.00	\$0.00
+ Delq TS Pen	\$0.00	\$0.00	\$0.00	\$0.00	\$0.00
+ Other Assess	\$48.10	\$41.82	\$39.52	\$97.00	\$107.36
+ Advert Fee	\$0.00	\$0.00	\$0.00	\$0.00	\$0.00
+ Tax Sale Fee	\$0.00	\$0.00	\$0.00	\$0.00	\$0.00
+ NSF Fee	\$0.00	\$0.00	\$0.00	\$0.00	\$0.00
PTRC	\$0.00	\$0.00	\$0.00	\$0.00	\$0.00
HMST Credit	\$0.00	\$0.00	\$0.00	\$0.00	\$0.00
Circuit Breaker	\$0.00	\$0.00	\$0.00	\$0.00	\$0.00
Over 65 CB	\$0.00	\$0.00	\$0.00	\$0.00	\$0.00
= Charges	\$818.00	\$632.94	\$550.08	\$565.98	\$572.78
- Surplus Transfer	\$0.00	\$0.00	\$0.00	\$0.00	\$0.00
- Credits	(\$409.00)	(\$632.94)	(\$550.08)	(\$565.98)	(\$572.78)
= Total Due	\$409.00	\$0.00	\$0.00	\$0.00	\$0.00

Payments (2020-2024) - Treasurer's Office

Year	Receipt #	Transaction Date	Amount
2023 Pay 2024	2407231	4/12/2024	\$409.00
2022 Pay 2023	2367500	10/19/2023	\$316.47
2022 Pay 2023	2301235	4/12/2023	\$316.47
2021 Pay 2022	2261511	10/11/2022	\$275.04
2021 Pay 2022	2196621	4/5/2022	\$275.04
2020 Pay 2021	2157327	10/18/2021	\$282.99
2020 Pay 2021	2093441	4/7/2021	\$282.99
2019 Pay 2020	2064301	10/26/2020	\$286.39
2019 Pay 2020	2071336	4/29/2020	\$286.39

Photos - Assessor's Office



Sketches - Assessor's Office

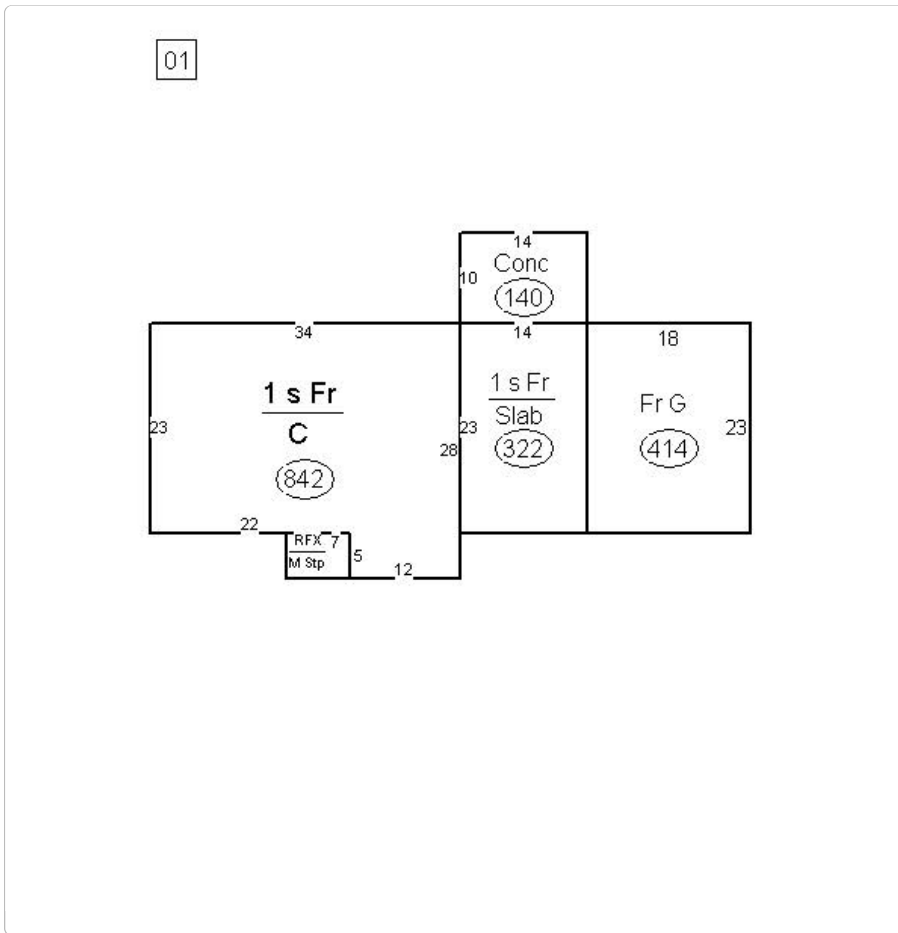

Property Record Card

[Property Record Card \(PDF\)](#)

Form 11

[Form 11 \(PDF\)](#)

Map



No data available for the following modules: Farm Land Computations - Assessor's Office, Homestead Allocations - Assessor's Office, Property History, Exemptions - Auditor's Office.

The information in this web site represents current data from a working file which is updated continuously. Information is believed reliable, but its accuracy cannot be guaranteed. No warranty, expressed or implied, is provided for the data herein, or its use.
[User Privacy Policy](#) | [GDPR Privacy Notice](#)
Last Data Upload: 10/15/2024, 2:39:54 PM

[Contact Us](#)

Developed by
SCHNEIDER
GEOSPATIAL

WARRANTY DEED

THIS INDENTURE WITNESSETH, That **RUTH A. PICKENS**, Of VIGO County, in the State of INDIANA,

Convey and Warrant to **TODD W. PICKENS**, Of VIGO County, in the State of INDIANA,

for and in consideration of the sum of One and 00/100 Dollar (\$1.00) and other good and valuable consideration, the receipt whereof is hereby acknowledged, the following described Real Estate in Vigo County, in the State of Indiana, to-wit:

Lot Number 203 in Maryland Subdivision of 136 acres off the West side of the North West quarter of Section 10, Township 11 North, Range 9 West.

Subject to any easements, agreements, streets, alleys, restrictions, covenants, building lines, and rights of way of public record including but not limited to:

a) Conditions, restrictions, covenants and easements as set forth on the Plat of Maryland Subdivision.

For information purposes only, the property address is purported to be:
4109 S. 9th Street, Terre Haute, Indiana 47802.

Tax bills should be sent to Grantee at such address unless otherwise indicated below.

Parcel No.: 84-09-10-102-010.000-004

ENTERED FOR TAXATION
Subject to final acceptance for Transfer

NOV 29 2018

JAMES W. BRANCH
VIGO COUNTY AUDITOR

IN WITNESS WHEREOF, the said Grantor has executed this deed on this 27TH day of NOVEMBER, 2018.

Ruth A. Pickens (Seal)
Ruth A. Pickens

STATE OF INDIANA)
) SS:
COUNTY OF VIGO)

Before me, the undersigned, a Notary Public in and for said County and State, this 27TH day of NOVEMBER, 2018, personally appeared Ruth A. Pickens who acknowledged the execution of the foregoing Warranty Deed to be the voluntary act and deed of Grantor, and who, having been duly sworn, stated that any representations therein contained are true.

IN WITNESS WHEREOF, I have hereunto subscribed my name and affixed my official seal.

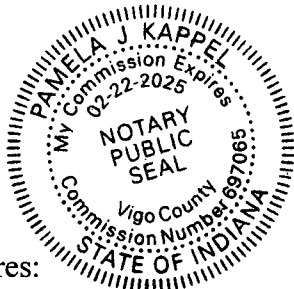

Pamela J. Kappel
Notary Public
Commission Number: _____

Printed Name _____

My County of Residence: _____

My Commission Expires: _____

This Instrument Was Prepared By: Matthew R. Effner, Attorney, Effner Law Firm, 19 S. 6th Street, Suite 1200, Terre Haute, IN 47807, (812) 238-4000, at the specific request of Honey Creek Vigo Title (HCVT) based solely on information supplied by HCVT without examination of title or abstract. Preparer makes no warranties, expressed or implied, regarding the title conveyed by it and assumes no liability for any error, inaccuracy or omission in this instrument resulting from the information provided, the parties hereto signifying their consent to this disclaimer by Grantor's execution and Grantee's acceptance of the instrument. HCVT-2018-0592.

I affirm under penalties for perjury that I have taken reasonable care to redact each Social Security number in this document, unless required by law. Matthew R. Effner

Mail Tax Bills To Grantee At: 4109 S 9th St., Terre Haute, IN 47802

Return Deed To: Honey Creek Vigo Title Services, Inc., 405 S. 6th Street, Terre Haute, IN 47807.

90-62 2207
JULY ENTERED FOR FILING
March 19 1985
Columbus, Indiana

PERSONAL REPRESENTATIVE'S DEED

Lee Ann Hankins, as Personal Representative of the Estate of William Rufus Lowe, deceased, by virtue of the decedent's Last Will and Testament, for good and sufficient consideration, conveys to LARRY W. PICKENS and RUTH A. PICKENS, husband and wife, the following described real estate in Vigo County, State of Indiana to-wit:

Lot Number 203 in Maryland Subdivision of 136 acres off the West side of the North West quarter of Section 10, Township 11 North, Range 9 West.

Grantor herein warrants and represents that the decedent, William Rufus Lowe and Hyla Jean Lowe were husband and wife at the time they obtained title to the above described real estate and that they remained continuously as husband and wife until the death of the said Hyla Jean Lowe, on or about the 9th day of August, 1978.

Subject to taxes pro-rated to date of sale.

IN WITNESS WHEREOF, the said Lee Ann Hankins, as Personal Representative of the Estate of William Rufus Lowe, deceased, has hereunto set her hand and seal this 14th day of March, 1985.

Lee Ann Hankins (SEAL)
LEE ANN HANKINS, AS PERSONAL
REPRESENTATIVE OF THE ESTATE OF
WILLIAM RUFUS LOWE, DECEASED.

STATE OF INDIANA)
: SS:
COUNTY OF VIGO)

Before me, the undersigned, a Notary Public, in and for said County and State, personally appeared Lee Ann Hankins, as Personal Representative of the Estate of William Rufus Lowe, deceased, and acknowledged the execution of said deed to be her voluntary act and deed for the uses and purposes expressed therein.

WITNESS MY HAND AND SEAL this 14th day of March, 1985.

Kimberly B. Holmberg
NOTARY PUBLIC AND RESIDENT OF
VIGO COUNTY, INDIANA
Kimberly B. Holmberg

MY COMMISSION EXPIRES -
12-21-88

This instrument prepared by: G. Steven Fleschner, Attorney-at-Law,
205 Ohio Street, Terre Haute, Indiana
(812) 235-6011

RECEIVED FOR RECORD T.C. 19 DAY OF March 1985 AT 3:30 O'CLOCK PM
RECORD 400 PAGE 114 JUDITH ANDERSON, RECORDER

STATE OF INDIANA)

COUNTY OF Vigo)

EXEMPT FROM DISCLOSURE

SURVIVORSHIP AFFIDAVIT

7130007

Ruth A. Pickens being of legal age, and duly sworn upon his/her oath deposes and says:

1. That I Ruth A. Pickens is the owner in fee simple title of the following described real estate located in Vigo County, Indiana to-wit:

SEE ATTACHED EXHIBIT A

2. That Larry Pickens and Ruth A. Pickens were vested in title as joint tenants with rights of survivorship at the time of Larry Pickens death. Attached is a copy of the death certificate.

3. That there has not been an administration upon the estate of Larry Pickens and that no administration is contemplated.

4. That the estate of Larry Pickens was not subject to any Federal Estate Tax.

5. That Ruth A. Pickens makes this affidavit for the purpose of causing the proper transfer of real estate title in Vigo County, Indiana.

Ruth A. Pickens

Signature

Ruth A. Pickens

Printed Name

Subscribed and sworn to me, a Notary Public in and for the County and State this day of April 11th 2005.

My commission expires:

County of Residence

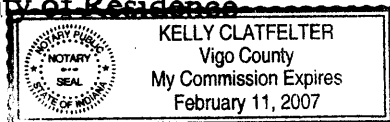

Kelly Clatfelter
Notary Public

DULY ENTERED FOR TAXATION
Subject to final acceptance for transfer

MAY 17 2005

TYPE/PRINT IN PERMANENT BLACK INK.

INSTRUCTIONS FOR SEE OTHER SIDE AND HANDBOOK.

DECEASED

VS 300
Rev 4/90
MO 580-0695
(4-90)

PARENTS

INFORMANT

DISPOSITION

SEE INSTRUCTIONS ON OTHER SIDE

CAUSE OF DEATH

CERTIFIER

CERTIFICATE OF DEATH

REGISTRAR'S NUMBER

124 - 92-201087

STATE FILE NUMBER

1. DECEASED'S NAME (First, Middle, Last)

LARRY PICKENS

2. SEX

Male

3. DATE OF DEATH (Month, Day, Year)

February 23, 1992

4. SOCIAL SECURITY NO.

██████████

5a. AGE - Last Birthday (Years)

43

5b. UNDER 1 YEAR

MONTHS

5c. UNDER 1 DAY

HOURS

6. DATE OF BIRTH (Month, Day, Year)

March 19, 1948

7. BIRTHPLACE (City and State or Foreign Country)

Terre Haute, Indiana

8. WAS DECEASED EVER IN U.S. ARMED FORCES?

☐ Yes ☒ No ☐ Unk.

9a. PLACE OF DEATH (check only one; see instructions on other side)

HOSPITAL: ☐ Inpatient ☐ ER/Outpatient ☐ DOA OTHER: ☐ Nursing Home ☐ Residence ☒ Other (specify) Operating Room

9b. FACILITY NAME (if not institution, give street and number)

St. Louis University Hospital

9c. CITY, TOWN, OR LOCATION OF DEATH

St. Louis

9d. COUNTY OF DEATH

--

10. MARITAL STATUS - Married, Never Married, Widowed, Divorced (Specify)

Married

11. SURVIVING SPOUSE'S NAME (If wife, give full maiden name)

Ruth Reising

12a. DECEASED'S USUAL OCCUPATION (Give kind of work done during most of working life. Do not use retired.)

Conductor

12b. KIND OF BUSINESS OR INDUSTRY

Conrail

13a. RESIDENCE - STATE

Indiana

13b. COUNTY

Vigo

13c. CITY, TOWN, OR LOCATION

Terre Haute

13d. ZIP CODE

47802

14. WAS DECEASED OF HISPANIC ORIGIN (Specify No or Yes - If yes, specify Cuban, Mexican, Puerto Rican, etc.)

No

15. RACE - American Indian, Black, White, etc. (Specify)

White

15a. RACE - American Indian, Black, White, etc. (Specify)

White

16. DECEASED'S EDUCATION (Specify only highest grade completed)

Elementary/Secondary (8-12) College (14 or 16)

17. FATHER'S NAME (First, Middle, Last)

No

18. MOTHER'S NAME (First, Middle, Maiden Surname)

Doris Hicks

19a. MAILING ADDRESS (Street and Number or Rural Route Number, City or Town, State, Zip Code)

4109 South Ninth, Terre Haute, Indiana 47802

20a. BURIAL CREMATION, OTHER (Specify)

Burial

20b. DATE OF DISPOSITION (Month, Day, Year)

2/26/92

21. SIGNATURE OF FUNERAL HOME LICENSEE OR PERSON ACTING AS SUCH

DeBaun Funeral Home, Terre Haute, Indiana

22a. NAME AND ADDRESS OF FACILITY

Roselawn Memorial Park

22b. FUNERAL ESTABLISHMENT LICENSE NUMBER

1934

23. PART I. Enter the diagnosis, injuries, or complications that caused the death. Do not enter the mode of dying, such as cardiac or respiratory arrest, shock, or heart failure. List only one cause on each line.

a. Thoracic Blunt Trauma

Approximate Interval Between Onset and Death

b. DUE TO (OR AS A CONSEQUENCE OF):

c. DUE TO (OR AS A CONSEQUENCE OF):

d. DUE TO (OR AS A CONSEQUENCE OF):

PART II. Other significant conditions contributing to death but not resulting in the underlying cause given in Part I.

25. MANNER OF DEATH

☐ Natural ☐ Pending Investigation ☒ Accident ☐ Suicide ☐ Could not be Determined ☐ Homicide

27a. DATE OF INJURY (Month, Day, Year)

2/23/92

27b. TIME OF INJURY

12:55A

27c. WAS INJURY ALCOHOL-RELATED? (Indicate)

No

27d. INJURY AT WORK?

No

27e. PLACE OF INJURY - At home, farm, street, factory, office building, etc. (specify)

highway exit

27f. LOCATION (Street and Number or Rural Route Number, City or Town, State)

IL 143 at I-70, Collinsville, IL

27g. DESCRIBE HOW INJURY OCCURRED

Driver MV-MV collision

28a. To the best of my knowledge, death occurred at the time, date and place and due to the cause(s) stated.

28b. DATE SIGNED (Month, Day, Year)

2/26/92

28c. TIME OF DEATH

3:53 A.

29. NAME AND ADDRESS OF CERTIFIER (PHYSICIAN, MEDICAL EXAMINER OR CORONER) (Type or Print)

Michael A. Graham, M.D. 1300 Clark Av. St. Louis, Mo.

30. MO. LICENSE NUMBER

R7B41

30a. WAS CASE REFERRED TO MEDICAL EXAMINER/CORONER?

Yes

31. NAME OF ATTENDING PHYSICIAN IF OTHER THAN CERTIFIER (Type or Print)

Michael A. Graham

32. REGISTRAR'S SIGNATURE (Type or Print)

Michael A. Graham

33. DATE RECEIVED BY LOCAL REGISTRAR (Month, Day, Year)

FEB 27 1992

THIS IS A CERTIFIED COPY OF AN ORIGINAL DOCUMENT
REFLECT IF ALTERED, REPHOTOGRAPHED, OR IF SEAL IMPRESSION CANNOT BE FELT

I hereby certify that this is a true copy of the certificate for the person named thereon as it now appears in the permanent record of the Bureau of Vital Statistics, the Division of Health of the City of St. Louis. Witness my hand as City Registrar of Vital Statistics and the seal of the Division of Health of said department this date of:
MAR 10 1992
City Registrar

3

EXHIBIT A

SITUATED IN THE COUNTY OF VIGO AND STATE OF INDIANA:

LOT NUMBER 203 IN MARYLAND SUBDIVISION OF 136 ACRES OFF THE
WEST SIDE OF THE NORTH WEST QUARTER OF SECTION 10, TOWNSHIP
11 NORTH, RANGE 9 WEST.

Permanent Parcel Number: 03-09-10-102-010
LARRY W. PICKENS AND RUTH A. PICKENS,
HUSBAND AND WIFE

4109 SOUTH 9TH STREET, TERRE HAUTE IN 47802
Loan Reference Number : 05461177/65/04642
First American Order No: 7130007
Identifier: f/ELS

Search Results for:

NAME: PICKENS, TODD (Super Search)



REGION: Vigo County, IN

DOCUMENTS VALIDATED THROUGH: 10/11/2024 2:36 PM

Showing 31 results

Filter:

Document Details	County	Date	Type	Name	Legal
2007012338	Vigo	08/17/2007	DEED : WARRANTY DEED	PICKENS, TODD Search Search THOMPSON, JACK Search THOMPSON, JACK L	Search 17-11N-9W SE
2007012339	Vigo	08/17/2007	MORT : MORTGAGE	PICKENS, TODD Search Search AMERICAN MORTGAGE SERVICE COMPANY	Search 17-11N-9W SE
2009017910	Vigo	12/30/2009	MORT : MORTGAGE	PICKENS, TODD Search Search CRANE FEDERAL CREDIT UNION	Search 17-11N-9W SE
2009017911	Vigo	12/30/2009	MORT : MORTGAGE	PICKENS, TODD Search Search CRANE FEDERAL CREDIT UNION	Search 17-11N-9W SE
2010000555	Vigo	01/20/2010	REL : MORTGAGE RELEASE	PICKENS, TODD Search Search MORTGAGE ELECTRONIC REGISTRATION SYSTEM	
2012013171	Vigo	08/27/2012	MISC : AFFIDAVIT	PICKENS, TODD Search Search CRANE FEDERAL CREDIT UNION	
2016006338	Vigo	06/24/2016	MORT : MORTGAGE	PICKENS, TODD Search Search CRANE CREDIT UNION	Search 17-11N-9W
2016006695	Vigo	07/05/2016	REL : MORTGAGE RELEASE	PICKENS, TODD Search Search CRANE CREDIT UNION Search CRANE FEDERAL CREDIT UNION	
2017008687	Vigo	08/29/2017	DEED : WARRANTY DEED	PICKENS, TODD Search Search PRESSEY, DEVUN M Search PRESSEY, MARK A Search PRESSEY, TINA M	Search 17-11N-9W SE
2017009056	Vigo	09/08/2017	REL : MORTGAGE RELEASE	PICKENS, TODD Search Search CRANE FEDERAL CREDIT UNION	

Document Details	County	Date	Type	Name	Legal
2017009057	Vigo	09/08/2017	REL : MORTGAGE RELEASE	PICKENS, TODD Search Search CRANE FEDERAL CREDIT UNION	
9711725	Vigo	08/07/1997	MORT : MORTGAGE	PICKENS, TODD W Search Search FIRST FARMERS STATE BANK	Search Search 31-10N-9W Search
Book 442, Page 2840	Vigo	08/07/1997	DEED : WARRANTY DEED	PICKENS, TODD W Search Search BURCHFIELD, CHRISTIE Search GODFREY, DARIN	Search Search 31-10N-9W Search
9716166	Vigo	10/17/1997	MORT : MORTGAGE	PICKENS, TODD W Search Search FIRST FARMERS STATE BANK	Search Search 31-10N-9W Search
983687	Vigo	03/06/1998	MORT : MORTGAGE	PICKENS, TODD W Search Search JOHNSON, CHARITY W Search FIRST FARMERS STATE BANK	Search Search 31-10N-9W Search
Book 443, Page 741	Vigo	03/06/1998	DEED : WARRANTY DEED	PICKENS, TODD W Search Search JOHNSON, CHARITY W Search PICKENS, TODD W	Search Search 31-10N-9W Search
9822488	Vigo	12/21/1998	REL : MORTGAGE RELEASE	PICKENS, TODD W Search Search FIRST FARMERS STATE BANK	Search Search Search
9822489	Vigo	12/21/1998	REL : MORTGAGE RELEASE	PICKENS, TODD W Search Search FIRST FARMERS STATE BANK	Search Search Search
997526	Vigo	04/29/1999	MORT : MORTGAGE	PICKENS, TODD W Search Search JOHNSON, CHARITY Search NEW STATE MORTGAGE	Search Search 31-10N-9W Search
999139	Vigo	05/24/1999	ASGN : ASSIGN MORTGAGE	PICKENS, TODD W Search Search JOHNSON, CHARITY Search OLD KENT BANK Search NEW STATE MORTGAGE LLC	Search Search Search

Document Details	County	Date	Type	Name	Legal
200124581	Vigo	11/20/2001	DEED : SHERIFF'S DEED	PICKENS, TODD W Search Search JOHNSON, CHARITY W Search VIGO COUNTY SHERIFF Search FIRST FARMERS STATE BANK	Search Lot 1 Block 0 BURCHFIELD PLACE
2003035131	Vigo	11/19/2003	DEED : WARRANTY DEED	PICKENS, TODD W Search Search DELAISE, ROBERT P Search DELAISE, SANDRA G Search PICKENS, THERESA K	Search 35-11N-9W NE
2003035135	Vigo	11/19/2003	MORT : MORTGAGE	PICKENS, TODD W Search Search PICKENS, THERESA K Search PSI FEDERAL CREDIT UNION	Search 35-11N-9W NE
2003035140	Vigo	11/19/2003	MORT : MORTGAGE	PICKENS, TODD W Search Search PICKENS, THERESA K Search PSI (TH DIV) FEDERAL CREDIT UNION	Search 35-11N-9W NE
2005016988	Vigo	09/12/2005	DEED : WARRANTY DEED	PICKENS, TODD W Search Search PICKENS, THERESA K Search POORMAN, MATTHEW Search REBMAN, STEPHANIE	Search 35-11N-9W NW
2018012617	Vigo	11/29/2018	DEED : WARRANTY DEED	PICKENS, TODD W Search Search PICKENS, RUTH A	Search Lot 203 MARYLAND SUB
2018012618	Vigo	11/29/2018	MORT : MORTGAGE	PICKENS, TODD W Search Search INDIANA STATE UNIVERSITY FEDERAL CREDIT UNION	Search Lot 203 MARYLAND SUB
2020003081	Vigo	03/06/2020	MORT : MORTGAGE	PICKENS, TODD W Search Search ISU FEDERAL CREDIT UNION	Search Lot 203 MARYLAND SUB
2022005876	Vigo	05/11/2022	MORT : MORTGAGE	PICKENS, TODD W Search Search INDIANA STATE UNIVERSITY FEDERAL CREDIT UNION	Search Lot 203 MARYLAND SUB

Document Details	County	Date	Type	Name	Legal
2022006303	Vigo	05/23/2022	REL : MORTGAGE RELEASE	PICKENS, TODD W Search Search INDIANA STATE UNIVERSITY FEDERAL CREDIT UNION	
2022006304	Vigo	05/23/2022	REL : MORTGAGE RELEASE	PICKENS, TODD W Search Search INDIANA STATE UNIVERSITY FEDERAL CREDIT UNION	

The data or information provided is based on information obtained from Indiana Courts, Clerks, Recorders, and Department of Revenue, and is not to be considered or used as an official record. Doxpop, LLC, the Division of State Court Administration, the Indiana Courts and Clerks of Court, the Indiana Recorders, and the Indiana Department of Revenue: 1) Do not warrant that the information is accurate or complete; 2) Make no representations regarding the identity of any persons whose names appear in the information; and 3) Disclaim any liability for any damages resulting from the release or use of the information. The user should verify the information by personally consulting the official record maintained by the court, clerk, recorder or Department of Revenue.

Copyright © 2002-2024 Doxpop, Ilc. All Rights Reserved

Search Results for:

LOT: 203
SUBDIVISION: MARYLAND SUB
REGION: Vigo County, IN
DOCUMENTS VALIDATED THROUGH: 10/11/2024 2:36 PM

Showing 10 results

Filter:

Document Details	County	Date	Type	Name	Legal
2003023957	Vigo	08/19/2003	MORT : MORTGAGE	Search PICKENS, RUTH A Search OLD NATIONAL BANK	Search Lot 203 MARYLAND SUB
2005008149	Vigo	05/17/2005	MISC : AFFIDAVIT	Search PICKENS, LARRY Search PICKENS, RUTH A Search PICKENS, RUTH A	Search Lot 203 MARYLAND SUB
2005008150	Vigo	05/17/2005	MORT : OPEN END MORTGAGE	Search PICKENS, RUTH A Search FIFTH THIRD BANK	Search Lot 203 MARYLAND SUB
2010015007	Vigo	11/15/2010	MORT : MORTGAGE	Search PICKENS, RUTH A Search FIFTH THIRD BANK	Search Lot 203 MARYLAND SUB
2015012462	Vigo	12/02/2015	MORT : MORTGAGE	Search PICKENS, RUTH A Search MORTGAGE ELECTRONIC REGISTRATION SYSTEMS	Search Lot 203 MARYLAND SUB
2015012463	Vigo	12/02/2015	MORT : MORTGAGE	Search PICKENS, RUTH A Search SECRETARY OF HOUSING AND URBAN DEVELOPMENT	Search Lot 203 MARYLAND SUB
2018012617	Vigo	11/29/2018	DEED : WARRANTY DEED	Search PICKENS, RUTH A Search PICKENS, TODD W	Search Lot 203 MARYLAND SUB
2018012618	Vigo	11/29/2018	MORT : MORTGAGE	Search PICKENS, TODD W Search INDIANA STATE UNIVERSITY FEDERAL CREDIT UNION	Search Lot 203 MARYLAND SUB
2020003081	Vigo	03/06/2020	MORT : MORTGAGE	Search PICKENS, TODD W Search ISU FEDERAL CREDIT UNION	Search Lot 203 MARYLAND SUB
2022005876	Vigo	05/11/2022	MORT : MORTGAGE	Search PICKENS, TODD W Search INDIANA STATE UNIVERSITY FEDERAL CREDIT UNION	Search Lot 203 MARYLAND SUB

The data or information provided is based on information obtained from Indiana Courts, Clerks, Recorders, and Department of Revenue, and is not to be considered or used as an official record. Doxpop, LLC, the Division of State Court Administration, the Indiana Courts and Clerks of Court, the Indiana Recorders, and the Indiana Department of Revenue: 1) Do not warrant that the information is accurate or complete; 2) Make no representations regarding the identity of any persons whose names appear in the information; and 3) Disclaim any liability for any damages resulting from the release or use of the information. The user should verify the information by personally consulting the official record maintained by the court, clerk, recorder or Department of Revenue.

Search Results for:

NAME: PICKENS, TODD W
REGION: Vigo County, IN
DOCUMENTS VALIDATED THROUGH: 10/11/2024 2:36 PM

Showing 20 results

Filter:

Document Details	County	Date	Type	Name	Legal
9711725	Vigo	08/07/1997	MORT : MORTGAGE	PICKENS, TODD W Search Search FIRST FARMERS STATE BANK	Search Search 31-10N-9W Search
Book 442, Page 2840	Vigo	08/07/1997	DEED : WARRANTY DEED	PICKENS, TODD W Search Search BURCHFIELD, CHRISTIE Search GODFREY, DARIN	Search Search 31-10N-9W Search
9716166	Vigo	10/17/1997	MORT : MORTGAGE	PICKENS, TODD W Search Search FIRST FARMERS STATE BANK	Search Search 31-10N-9W Search
983687	Vigo	03/06/1998	MORT : MORTGAGE	PICKENS, TODD W Search Search JOHNSON, CHARITY W Search FIRST FARMERS STATE BANK	Search Search 31-10N-9W Search
Book 443, Page 741	Vigo	03/06/1998	DEED : WARRANTY DEED	PICKENS, TODD W Search Search PICKENS, TODD W Search JOHNSON, CHARITY W	Search Search 31-10N-9W Search
9822488	Vigo	12/21/1998	REL : MORTGAGE RELEASE	PICKENS, TODD W Search Search FIRST FARMERS STATE BANK	Search Search Search
9822489	Vigo	12/21/1998	REL : MORTGAGE RELEASE	PICKENS, TODD W Search Search FIRST FARMERS STATE BANK	Search Search Search
997526	Vigo	04/29/1999	MORT : MORTGAGE	PICKENS, TODD W Search Search JOHNSON, CHARITY Search NEW STATE MORTGAGE	Search Search 31-10N-9W Search

Document Details	County	Date	Type	Name	Legal
999139	Vigo	05/24/1999	ASGN : ASSIGN MORTGAGE	PICKENS, TODD W Search Search JOHNSON, CHARITY Search OLD KENT BANK Search NEW STATE MORTGAGE LLC	Search Search Search
200124581	Vigo	11/20/2001	DEED : SHERIFF'S DEED	PICKENS, TODD W Search Search JOHNSON, CHARITY W Search VIGO COUNTY SHERIFF Search FIRST FARMERS STATE BANK	Search Lot 1 Block 0 BURCHFIELD PLACE
2003035131	Vigo	11/19/2003	DEED : WARRANTY DEED	PICKENS, TODD W Search Search DELAISE, ROBERT P Search DELAISE, SANDRA G Search PICKENS, THERESA K	Search 35-11N-9W NE
2003035135	Vigo	11/19/2003	MORT : MORTGAGE	PICKENS, TODD W Search Search PICKENS, THERESA K Search PSI FEDERAL CREDIT UNION	Search 35-11N-9W NE
2003035140	Vigo	11/19/2003	MORT : MORTGAGE	PICKENS, TODD W Search Search PICKENS, THERESA K Search PSI (TH DIV) FEDERAL CREDIT UNION	Search 35-11N-9W NE
2005016988	Vigo	09/12/2005	DEED : WARRANTY DEED	PICKENS, TODD W Search Search PICKENS, THERESA K Search POORMAN, MATTHEW Search REBMAN, STEPHANIE	Search 35-11N-9W NW
2018012617	Vigo	11/29/2018	DEED : WARRANTY DEED	PICKENS, TODD W Search Search PICKENS, RUTH A	Search Lot 203 MARYLAND SUB
2018012618	Vigo	11/29/2018	MORT : MORTGAGE	PICKENS, TODD W Search Search INDIANA STATE UNIVERSITY FEDERAL CREDIT UNION	Search Lot 203 MARYLAND SUB

Document Details	County	Date	Type	Name	Legal
2020003081	Vigo	03/06/2020	MORT : MORTGAGE	PICKENS, TODD W Search Search ISU FEDERAL CREDIT UNION	Search Lot 203 MARYLAND SUB
2022005876	Vigo	05/11/2022	MORT : MORTGAGE	PICKENS, TODD W Search Search INDIANA STATE UNIVERSITY FEDERAL CREDIT UNION	Search Lot 203 MARYLAND SUB
2022006303	Vigo	05/23/2022	REL : MORTGAGE RELEASE	PICKENS, TODD W Search Search INDIANA STATE UNIVERSITY FEDERAL CREDIT UNION	
2022006304	Vigo	05/23/2022	REL : MORTGAGE RELEASE	PICKENS, TODD W Search Search INDIANA STATE UNIVERSITY FEDERAL CREDIT UNION	

The data or information provided is based on information obtained from Indiana Courts, Clerks, Recorders, and Department of Revenue, and is not to be considered or used as an official record. Doxpop, LLC, the Division of State Court Administration, the Indiana Courts and Clerks of Court, the Indiana Recorders, and the Indiana Department of Revenue: 1) Do not warrant that the information is accurate or complete; 2) Make no representations regarding the identity of any persons whose names appear in the information; and 3) Disclaim any liability for any damages resulting from the release or use of the information. The user should verify the information by personally consulting the official record maintained by the court, clerk, recorder or Department of Revenue.

Copyright © 2002-2024 Doxpop, Ilc. All Rights Reserved

Search Results for:

NAME: pickens, larry (Super Search)



REGION: Vigo County, IN

DOCUMENTS VALIDATED THROUGH: 10/11/2024 2:36 PM

Showing 2 results

Filter:

Document Details	County	Date	Type	Name	Legal
2005008149	Vigo	05/17/2005	MISC : AFFIDAVIT	PICKENS, LARRY Search Search PICKENS, RUTH A Search PICKENS, RUTH A	Search Lot 203 MARYLAND SUB
Book 400, Page 114	Vigo		DEED : DEED	PICKENS, LARRY W Search Search HANKINS, LEE ANN Search LOWE, WILLIAM RUFUS Search PICKENS, RUTH A	

The data or information provided is based on information obtained from Indiana Courts, Clerks, Recorders, and Department of Revenue, and is not to be considered or used as an official record. Doxpop, LLC, the Division of State Court Administration, the Indiana Courts and Clerks of Court, the Indiana Recorders, and the Indiana Department of Revenue: 1) Do not warrant that the information is accurate or complete; 2) Make no representations regarding the identity of any persons whose names appear in the information; and 3) Disclaim any liability for any damages resulting from the release or use of the information. The user should verify the information by personally consulting the official record maintained by the court, clerk, recorder or Department of Revenue.

Copyright © 2002-2024 Doxpop, Ilc. All Rights Reserved