

68-05-12-283-117.000-002

General Information

Parcel Number
68-05-12-283-117.000-002

Local Parcel Number
013-00410-00

Tax ID:

Routing Number
002 004 057.00

Property Class 510
1 Family Dwell - Platted Lot

Year: 2024

Location Information

County
Randolph

Township
FRANKLIN TOWNSHIP

District 002 (Local 013)
RIDGEVILLE TOWN

School Corp 6825
RANDOLPH CENTRAL

Neighborhood 10120-002
Ridgeville (Res)

Section/Plat
0012

Location Address (1)
109 W FIRST ST
RIDGEVILLE, IN 47380

Zoning

Subdivision

Lot

Market Model
10120-002 - Residential

Characteristics

Topography Flood Hazard
Level ☐

Public Utilities ERA
All ☐

Streets or Roads TIF
Paved ☐

Neighborhood Life Cycle Stage
Static

Printed Monday, April 7, 2025

Review Group 2020

Moyer, William C & Kori M Moyer

Ownership

Moyer, William C & Kori M Moyer
109 W 1st St
Ridgeville, IN 47380

Legal

Newtown 72' W End Lot 2 Blk 4 Newtown 72' W End
Lot 3 Blk 4



Valuation Records (Work In Progress values are not certified values and are subject to change)

2024	Assessment Year	2024	2023	2022	2022	2021
WIP	Reason For Change	GenReval	GenReval	GenReval	GenReval	R-2021
03/27/2024	As Of Date	04/06/2024	04/11/2023	06/29/2022	01/01/2022	01/01/2021
Indiana Cost Mod	Valuation Method	Indiana Cost Mod	Indiana Cost Mod	Indiana Cost Mod	Indiana Cost Mod	Indiana Cost Mod
1.0000	Equalization Factor	1.0000	1.0000	1.0000	1.0000	1.0000
	Notice Required	<input type="checkbox"/>	<input type="checkbox"/>	<input checked="" type="checkbox"/>	<input type="checkbox"/>	<input type="checkbox"/>
\$7,000	Land	\$7,000	\$7,000	\$7,000	\$7,000	\$5,600
\$7,000	Land Res (1)	\$7,000	\$7,000	\$7,000	\$7,000	\$5,600
\$0	Land Non Res (2)	\$0	\$0	\$0	\$0	\$0
\$0	Land Non Res (3)	\$0	\$0	\$0	\$0	\$0
\$36,100	Improvement	\$36,100	\$25,700	\$26,100	\$26,100	\$26,400
\$34,200	Imp Res (1)	\$34,200	\$24,400	\$24,700	\$24,700	\$25,000
\$0	Imp Non Res (2)	\$0	\$0	\$0	\$0	\$0
\$1,900	Imp Non Res (3)	\$1,900	\$1,300	\$1,400	\$1,400	\$1,400
\$43,100	Total	\$43,100	\$32,700	\$33,100	\$33,100	\$32,000
\$41,200	Total Res (1)	\$41,200	\$31,400	\$31,700	\$31,700	\$30,600
\$0	Total Non Res (2)	\$0	\$0	\$0	\$0	\$0
\$1,900	Total Non Res (3)	\$1,900	\$1,300	\$1,400	\$1,400	\$1,400

Land Data (Standard Depth: Res 132', CI 132' Base Lot: Res 0' X 0', CI 0' X 0')

Land Type	Pricing Method	Soil ID	Act Front.	Size	Factor	Rate	Adj. Rate	Ext. Value	Infl. %	Market Factor	Cap 1	Cap 2	Cap 3	Value
F	OF		72	72x88	0.84	\$115	\$97	\$6,984	0%	1.0000	100.00	0.00	0.00	\$6,980

109 W FIRST ST

Transfer of Ownership

Date	Owner	Doc ID	Code	Book/Page	Adj Sale Price	V/I
05/21/2008	Moyer, William C & Ko		WD	/	\$35,000	I
07/06/2006	BOWDELL, WILLIAM		CW	/	\$8,000	I
03/23/2006	FIRST NATIONAL BA		SH	/	\$10,000	I
01/31/2000	THEURER, JOSEPH		WD	/		I
01/31/2000	STOVER, DONAL L &		WD	2448/	\$26,000	I
08/02/1995	STOVER, DONAL L &		WD	/		I

Res

510, 1 Family Dwell - Platted Lot

Ridgeville (Res)/10120-002 1/2

Notes

6/10/2024 RE25: CHANGED LAND TO ACRES. CHECKED ALLOCATIONS. PAY 26
8/24/2020 OFNC: NEW CONSTRUCTION Added Utlished(10x16x8) and AC to Dwell. 21 pay 22. (MD 8/24/20)
7/31/2020 RE21: Reassessment 2021 Added fin space to attic. removed utlished for 21 pay 22. SC
8/1/2016 RE17: Reassessment 2017 OFP REMOVED/ADDED 12X24 CANOPY/WD DK W-RAIL 8/1/16 BJF

Land Computations

Calculated Acreage	0.15
Actual Frontage	72
Developer Discount	<input type="checkbox"/>
Parcel Acreage	0.00
81 Legal Drain NV	0.00
82 Public Roads NV	0.00
83 UT Towers NV	0.00
9 Homesite	0.00
91/92 Acres	0.00
Total Acres Farmland	0.00
Farmland Value	\$0
Measured Acreage	0.00
Avg Farmland Value/Acre	0.0
Value of Farmland	\$0
Classified Total	\$0
Farm / Classified Value	\$0
Homesite(s) Value	\$0
91/92 Value	\$0
Supp. Page Land Value	
CAP 1 Value	\$7,000
CAP 2 Value	\$0
CAP 3 Value	\$0
Total Value	\$7,000

General Information

OccupancySingle-Family
DescriptionSingle-Family R 01
Story Height1
Style12
Finished Area1204 sqft
Make

Floor Finish

☐ Earth☐ Tile
☐ Slab☒ Carpet
☒ Sub & Joist☒ Unfinished
☒ Wood☐ Other
☐ Parquet

Wall Finish

☒ Plaster/Drywall☐ Unfinished
☒ Paneling☐ Other
☐ Fiberboard

Roofing

☐ Built-Up☒ Metal☐ Asphalt☐ Slate☐ Tile
☐ Wood Shingle☐ Other

Exterior Features

Description	Area	Value
Porch, Enclosed Frame	108	\$0
Porch, Enclosed Frame	96	\$0
Wood Deck	288	\$0
Canopy, Shed Type	288	\$0

Plumbing

	#	TF
Full Bath	1	3
Half Bath	0	0
Kitchen Sinks	1	1
Water Heaters	1	1
Add Fixtures	0	0
Total	3	5

Accommodations

Bedrooms	3
Living Rooms	0
Dining Rooms	0
Family Rooms	0
Total Rooms	7

Heat Type

Central Warm Air

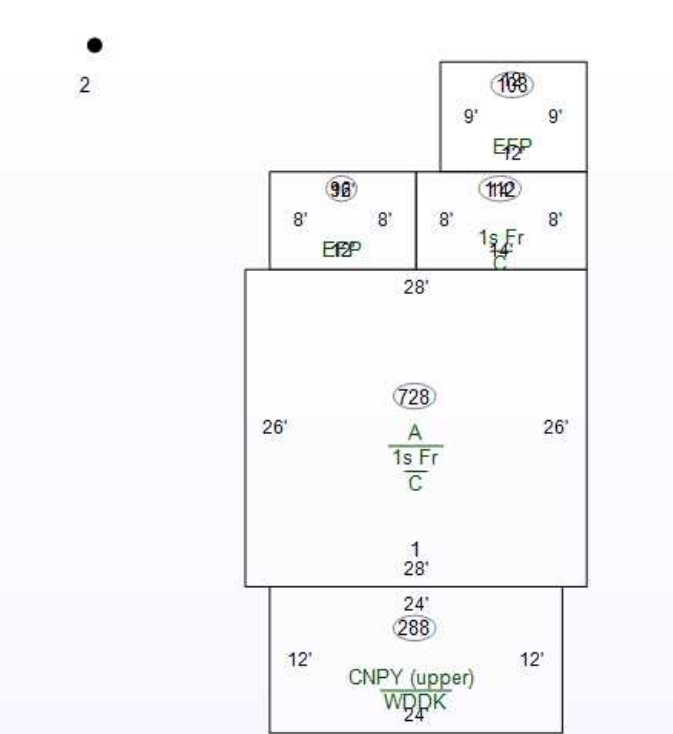

Specialty Plumbing

Description	Count	Value
-------------	-------	-------

Cost Ladder

Floor	Constr	Base	Finish	Value	Totals
1	1Fr	840	840	\$71,200	
2					
3					
4					
1/4					
1/2					
3/4					
Attic		728	364	\$10,200	
Bsmt					
Crawl		840	0	\$5,400	
Slab					

Total Base \$86,800

Adjustments 1 Row Type Adj. x 1.00 \$86,800

Unfin Int (-)	\$0
Ex Liv Units (+)	\$0
Rec Room (+)	\$0
Loft (+)	\$0
Fireplace (+)	\$0
No Heating (-)	\$0
A/C (+)	1:840 A:364 \$4,200
No Elec (-)	\$0
Plumbing (+ / -)	5 - 5 = 0 x \$0 \$0
Spec Plumb (+)	\$0
Elevator (+)	\$0

Sub-Total, One Unit \$91,000

Sub-Total, 1 Units

Exterior Features (+)	\$16,100	\$107,100
Garages (+) 0 sqft	\$0	\$107,100
Quality and Design Factor (Grade)	0.90	
Location Multiplier	0.87	

Replacement Cost \$83,859

Summary of Improvements

Description	Story Height	Constr Type	Grade	Year Built	Eff Year	Eff Age	Co nd	Base Rate	LCM	Adj Rate	Size	RCN	Norm Dep	Remain. Value	Abn Obs	PC	Nbhd	Mrkt	Cap 1	Cap 2	Cap 3	Improv Value
1: Single-Family R 01	1	Wood Fr	D+2	1886	1886	138	G		0.87		1,568 sqft	\$83,859	45%	\$46,120	0%	100%	1.000	0.742	100.00	0.00	0.00	\$34,200
2: Utility Shed R 01	1		C	2020	2020	4	A	\$21.43	0.87	\$18.64	10'x16'	\$2,983	15%	\$2,540	0%	100%	1.000	0.742	0.00	0.00	100.00	\$1,900

DULY ENTERED FOR TAXATION

THIS 21 DAY OF May 08

David B. Kelly
AUDITOR OF RANDOLPH COUNTY

JANE A GROVE 2P
RANDOLPH COUNTY RECORDER, INDIANA
DLP Date 05/21/2008 Time 13:08:22

WARRANTY DEED

I 20082157

Page 1 of 2

THIS INDENTURE WITNESSETH THAT: WILLIAM H. BOWDELL and PAMELA S. BOWDELL, Husband and Wife, Grantor(s), CONVEYS AND WARRANTS to WILLIAM C. MOYER and KORI M. MOYER, Joint Tenants with Rights of Survivorship, Grantee(s), for the sum of One (\$1.00) dollar and other valuable consideration, the receipt whereof is hereby acknowledged, the following described Real Estate in RANDOLPH County in the State of Indiana, to-wit:

Seventy-two (72) feet off of the West end of Lots numbered Two (2) and Three (3) in Block numbered Four (4) in the Original Plat of the Town of Newton, now Ridgeville, Indiana, in Randolph County, Indiana.

RANDOLPH COUNTY

Commonly known as: 109 WEST 1ST STREET, RIDGEVILLE, INDIANA 47580

Key # 013 00410 00 8-117

68-05-12-283-117.000-002

Subject to all easements, restrictions, assessments, rights-of-way of record and all visible, unrecorded easements and to all matters that would be discovered by an accurate inspection and Indiana Land Title Association minimum detail survey of the real estate.

Subject to the 2006 taxes due and payable in 2007 and thereafter.

080557RO

IN WITNESS WHEREOF, the said grantor(s) above named have/has hereunto set his/her/their hand(s) and seal(s), this 7th day of May, 2008

William H. Bowdell
WILLIAM H. BOWDELL

Pamela S. Bowdell
PAMELA S. BOWDELL

STATE OF INDIANA, COUNTY OF RANDOLPH, SS:

Before me, the undersigned Notary Public, in and for said County and State, this 7th day of May, 2008, personally appeared WILLIAM H. BOWDELL and PAMELA S. BOWDELL, Husband and Wife, Grantor(s) in the above conveyance, and acknowledged their execution of this Deed.

IN WITNESS WHEREOF, I have hereunto subscribed my name and affixed my official seal.

My Commission Expires
Tiffany Yun Koo-Bullis
Notary Public, State of Indiana
Delaware County
No: 540978



My Commission Expires

This Deed was Prepared By SANSBERRY DICKMANN FREEMAN & BUILTA
By Jonathan R. Builta, 1001 Jackson Street, Anderson, IN

Tiffany Yun Koo-Bullis, Notary Public
A resident of _____ County, Indiana

"I affirm, under the penalties for perjury, that I have taken reasonable care to redact each Social Security number in this document, unless required by law." ROBIN L. THOMAS

Grantee's Address and Mail to: 109 West 1st Street Ridgville IN 47580

Send Tax Statement To: SNM

Auditor's Stamp:

Recorder's Stamp:

Search Results for:

NAME: MOYER WILLIAM (Super Search)

REGION: Randolph County, IN
DOCUMENTS VALIDATED THROUGH: 08/4/2025 2:54 PM

Showing 43 results

Filter:

Document Details	County	Date	Type	Name	Legal
Book 232, Page 303	Randolph	12/16/1981	DEED : WARRANTY DEED	MOYER, WILLIAM JODY Search Search CLAPP, MARY LOUISE Search WOLFE, JOSEPH RICHARD Search MOYER, ANNA C	Non-land Search Lot 9 Block 6 ORIGINAL PLAT RIDGEVILLE Search Lot 12 Block 6 ORIGINAL PLAT RIDGEVILLE
952789	Randolph	03/14/1995	DEED : WARRANTY DEED	MOYER, WILLIAM JODY Search Search MOYER, ANNA C Search HESS, VIRGIL K	Search Lot 9 Block 6 ORIGINAL PLAT Search Lot 12 Block 6 ORIGINAL PLAT
952809	Randolph	03/16/1995	REL : MORTGAGE RELEASE	MOYER, WILLIAM JODY Search Search MOYER, ANNA C Search MUTUAL FEDERAL SAVINGS BANK	Non-land
952810	Randolph	03/16/1995	REL : MORTGAGE RELEASE	MOYER, WILLIAM JODY Search Search MUTUAL FEDERAL SAVINGS BANK	Non-land
972970	Randolph	03/19/1997	REL : MORTGAGE RELEASE	MOYER, WILLIAM W Search Search MOYER, WILMA ARLENE Search PEOPLES LOAN & TRUST BANK	Non-land
975921	Randolph	09/29/1997	DEED : WARRANTY DEED	MOYER, WILLIAM JODY Search Search STAGGS, JAMES A Search MOYER, ANNA CHRISTINE	Search Lot 90 ENGLE AND MARKLES ADDITION
975922	Randolph	09/29/1997	MORT : MORTGAGE	MOYER, WILLIAM JODY Search Search MOYER, ANNA CHRISTINE Search FIRST CHICAGO NBD MORTGAGE COMPANY	Search Lot 90 ENGLE AND MARKLES ADDITION

Document Details	County	Date	Type	Name	Legal
997487	Randolph	10/29/1999	ASGN : ASSIGNMENT	MOYER, WILLIAM JODY Search Search FIRST CHICAGO NBD MORTGAGE COMPANY Search MOYER, ANNA CHRISTINE Search MORTGAGE ELECTRONIC REGISTRATION SYSTEMS INC	
023462	Randolph	03/18/2002	MORT : MORTGAGE	MOYER, WILLIAM Search Search AMERICAS WHOLESALE LENDER	Search Lot 90 ENGLE & MARKLES ADDITION
023461	Randolph	03/18/2002	MORT : MORTGAGE	MOYER, WILLIAM JODY Search Search MOYER, ANNA CHRISTINE Search AMERICAS WHOLESALE LENDER Search MORTGAGE ELECTRONIC REGISTRATION SYSTEMS INC	Search Lot 90 ENGLE & MARKLES ADDITION
023671	Randolph	04/01/2002	REL : MORTGAGE RELEASE	MOYER, WILLIAM JODY Search Search MOYER, ANNA CHRISTINE Search MORTGAGE ELECTRONIC REGISTRATION SYSTEMS INC	
20033574	Randolph	06/18/2003	DEED : QUIT CLAIM DEED	MOYER, WILLIAM J Search Search MOYER, ANNA C	Search Lot 90 ENGLE & MARKLES ADDITION
20033575	Randolph	06/18/2003	MORT : MORTGAGE	MOYER, WILLIAM J Search Search COUNTRYWIDE HOME LOANS INC Search MORTGAGE ELECTRONIC REGISTRATION SYSTEMS INC	Search Lot 90 ENGLE & MARKLES ADDITION
20034042	Randolph	07/11/2003	REL : MORTGAGE RELEASE	MOYER, WILLIAM Search Search AMERICAS WHOLESALE LENDER Search COUNTRYWIDE HOME LOANS INC	

Document Details	County	Date	Type	Name	Legal
20034371	Randolph	07/28/2003	REL : MORTGAGE RELEASE	MOYER, WILLIAM JODY Search Search MOYER, ANNA CHRISTINE Search MORTGAGE ELECTRONIC REGISTRATION SYSTEMS INC	
20044272	Randolph	08/30/2004	DEED : WARRANTY DEED	MOYER, WILLIAM J Search Search COX, DANA M Search COX, SHARON D Search REED, CHERYL L see details for more	Search Lot 3 Block 11 EDGERS ADDITION
20044273	Randolph	08/30/2004	MORT : MORTGAGE	MOYER, WILLIAM J Search Search REED, CHERYL L Search COUNTRYWIDE HOME LOANS INC Search MORTGAGE ELECTRONIC REGISTRATION SYSTEMS INC	Search Lot 3 Block 11 EDGERS ADDITION
20055059	Randolph	10/19/2005	MORT : MORTGAGE	MOYER, WILLIAM J Search Search REED, CHERYL L Search COUNTRYWIDE BANK NA Search MORTGAGE ELECTRONIC REGISTRATION SYSTEMS INC	Search Lot 3 Block 11 EDGERS ADDITION
20055375	Randolph	11/08/2005	DEED : WARRANTY DEED	MOYER, WILLIAM Search Search BESHAY, SUSAN C Search REED, CHERYL	Search Lot 1 Block 11 EDGERS ADDITION Search Lot 2 Block 11 EDGERS ADDITION
20082157	Randolph	05/21/2008	DEED : WARRANTY DEED	MOYER, WILLIAM C Search Search BOWDELL, PAMELA S Search BOWDELL, WILLIAM H Search MOYER, KORI M	Search Lot 2 Block 4 ORIGINAL PLAT RIDGEVILLE Search Lot 3 Block 4 ORIGINAL PLAT RIDGEVILLE
20082158	Randolph	05/21/2008	MORT : MORTGAGE	MOYER, WILLIAM C Search Search JPMORGAN CHASE BANK NA	Search Lot 2 Block 4 ORIGINAL PLAT RIDGEVILLE Search Lot 3 Block 4 ORIGINAL PLAT RIDGEVILLE

Document Details	County	Date	Type	Name	Legal
20085587	Randolph	12/03/2008	MORT : MORTGAGE	MOYER, WILLIAM J Search Search REED, CHERYL L Search COUNTRYWIDE BANK FSB Search MORTGAGE ELECTRONIC REGISTRATION SYSTEMS INC	Search Lot 3 Block 11 EDGER'S ADDITION
20086065	Randolph	12/22/2008	REL : MORTGAGE RELEASE	MOYER, WILLIAM J Search Search REED, CHERYL L Search MORTGAGE ELECTRONIC REGISTRATION SYSTEMS INC	
20086081	Randolph	12/23/2008	MORT : MORTGAGE	MOYER, WILLIAM W Search Search MOYER, WILMA ARLENE Search MORTGAGE SHOP LLC	Search Lot 9 GEORGE LEMAUX SR.'S ADDITION Search Lot 12 GEORGE LEMAUX SR.'S ADDITION
20086082	Randolph	12/23/2008	ASGN : ASSIGNMENT	MOYER, WILLIAM W Search Search MORTGAGE SHOP LLC Search MOYER, WILMA ARLENE Search METLIFE HOME LOANS	
20086083	Randolph	12/23/2008	MORT : MORTGAGE	MOYER, WILLIAM W Search Search MOYER, WILMA ARLENE Search HOUSING AND URBAN DEVELOPMENT SECRETARY OF Search SECRETARY OF HOUSING AND URBAN DEVELOPMENT	Search Lot 9 GEORGE LEMAUX SR.'S ADDITION Search Lot 12 GEORGE LEMAUX SR.'S ADDITION
20124696	Randolph	10/15/2012	REL : MORTGAGE RELEASE	MOYER, WILLIAM J Search Search REED, CHERYL L Search MORTGAGE ELECTRONIC REGISTRATION SYSTEMS INC	
20124974	Randolph	11/02/2012	MORT : MORTGAGE	MOYER, WILLIAM J Search Search MOYER, CHERYL L Search REED, CHERYL L Search MAINSOURCE BANK	Search Lot 3 Block 11 EDGER'S ADDITION

Document Details	County	Date	Type	Name	Legal
20125849	Randolph	12/27/2012	ASGN : ASSIGNMENT	MOYER, WILLIAM W Search Search METLIFE HOME LOANS Search MOYER, WILMA ARLENE Search CHAMPION MORTGAGE COMPANY	
20151056	Randolph	03/26/2015	DEED : AFFIDAVIT OF TRANSFER	MOYER, WILLIAM W Search Search MOYER, WILMA ARLENE	Search Lot 9 GEORGE LAMAUX SR ADDITION Search Lot 12 GEORGE LAMAUX SR ADDITION
20161173	Randolph	03/08/2016	ASGN : ASSIGNMENT	MOYER, WILLIAM W Search Search CHAMPION MORTGAGE COMPANY Search MOYER, WILMA ARLENE Search HOUSING AND URBAN DEVELOPMENT SECRETARY OF see details for more	
20170643	Randolph	03/13/2017	REL : MORTGAGE RELEASE	MOYER, WILLIAM J Search Search MOYER, CHERYL L Search REED, CHERYL L Search MAINSOURCE BANK	
20171948	Randolph	06/15/2017	MORT : MORTGAGE	MOYER, WILLIAM J Search Search MOYER, CHERYL Search REED, CHERYL L Search MAINSOURCE BANK	Search Lot 1 Block 11 EDGERS ADDITION Search Lot 2 Block 11 EDGERS ADDITION
20172050	Randolph	06/23/2017	MORT : MORTGAGE	MOYER, WILLIAM J Search Search MOYER, CHERYL Search REED, CHERYL L Search MAINSOURCE BANK	Search Lot 1 Block 11 EDGAR'S ADDITION Search Lot 2 Block 11 EDGAR'S ADDITION Search Lot 3 Block 11 EDGAR'S ADDITION
20172612	Randolph	07/24/2017	REL : MORTGAGE RELEASE	MOYER, WILLIAM J Search Search MOYER, CHERYL Search REED, CHERYL L Search MAINSOURCE BANK	
20184393	Randolph	11/19/2018	DEED : WARRANTY DEED	MOYER, WILLIAM J Search Search POLITES, MICHAEL S Search POLITES, STACY M	Search Lot 90 ENGLE & MARKLE ADDITION

Document Details	County	Date	Type	Name	Legal
20184510	Randolph	11/30/2018	REL : MORTGAGE RELEASE	MOYER, WILLIAM J Search Search MORTGAGE ELECTRONIC REGISTRATION SYSTEMS INC	
20193269	Randolph	09/06/2019	REL : MORTGAGE RELEASE	MOYER, WILLIAM J Search Search REED, CHERYL L Search COUNTRYWIDE HOME LOANS INC Search MORTGAGE ELECTRONIC REGISTRATION SYSTEMS INC	
20211909	Randolph	04/14/2021	REL : MORTGAGE RELEASE	MOYER, WILLIAM J Search Search MOYER, CHERYL Search REED, CHERYL L Search FIRST FINANCIAL BANK	
20214989	Randolph	10/20/2021	DEED : QUIT CLAIM DEED	MOYER, WILLIAM Search Search MOYER, WILLIAM J Search COX, CHERYL Search REED, CHERYL see details for more	Search Lot 1 Block 11 EDGAR'S ADDITION Search Lot 2 Block 11 EDGAR'S ADDITION Search Lot 3 Block 11 EDGAR'S ADDITION
20231497	Randolph	04/14/2023	ASGN : ASSIGNMENT	MOYER, WILLIAM C Search Search JPMORGAN CHASE BANK NA Search MIDFIRST BANK	
20243371	Randolph	09/04/2024	DEED : QUIT CLAIM DEED	MOYER, WILLIAM C Search Search CHAMP, GREGORY Search CHAMP, GREGORY O Search MOYER, KORI M	Search Lot 2 WARD'S ADDITION
20244172	Randolph	11/22/2024	DEED : QUIT CLAIM DEED	MOYER, WILLIAM Search Search MOYER, KORI Search SCHWIETERMAN, SCOTT	Search Lot 2 WARD'S ADDITION

The data or information provided is based on information obtained from Indiana Courts, Clerks, Records, and Department of Revenue, and is not to be considered or used as an official record. Doxpop, LLC, the Division of State Court Administration, the Indiana Courts and Clerks of Court, the Indiana Records, and the Indiana Department of Revenue: 1) Do not warrant that the information is accurate or complete; 2) Make no representations regarding the identity of any persons whose names appear in the information; and 3) Disclaim any liability for any damages resulting from the release or use of the information. The user should verify the information by personally consulting the official record maintained by the court, clerk, recorder or Department of Revenue.

Search Results for:

NAME: MOYER KORI (Super Search)

REGION: Randolph County, IN
DOCUMENTS VALIDATED THROUGH: 08/4/2025 2:54 PM

Showing 4 results

Filter:

Document Details	County	Date	Type	Name	Legal
20082157	Randolph	05/21/2008	DEED : WARRANTY DEED	MOYER, KORI M Search Search BOWDELL, PAMELA S Search BOWDELL, WILLIAM H Search MOYER, WILLIAM C	Search Lot 2 Block 4 ORIGINAL PLAT RIDGEVILLE Search Lot 3 Block 4 ORIGINAL PLAT RIDGEVILLE
20141182	Randolph	03/05/2014	DEED : CEMETERY DEED	MOYER, KORI M Search Search FOUNTAIN PARK CEMETERY	Search Lot 239 FOUNTAIN PARK CEMETERY
20243371	Randolph	09/04/2024	DEED : QUIT CLAIM DEED	MOYER, KORI M Search Search CHAMP, GREGORY Search CHAMP, GREGORY O Search MOYER, WILLIAM C	Search Lot 2 WARD'S ADDITION
20244172	Randolph	11/22/2024	DEED : QUIT CLAIM DEED	MOYER, KORI Search Search MOYER, WILLIAM Search SCHWIETERMAN, SCOTT	Search Lot 2 WARD'S ADDITION

The data or information provided is based on information obtained from Indiana Courts, Clerks, Recorders, and Department of Revenue, and is not to be considered or used as an official record. Doxpop, LLC, the Division of State Court Administration, the Indiana Courts and Clerks of Court, the Indiana Recorders, and the Indiana Department of Revenue: 1) Do not warrant that the information is accurate or complete; 2) Make no representations regarding the identity of any persons whose names appear in the information; and 3) Disclaim any liability for any damages resulting from the release or use of the information. The user should verify the information by personally consulting the official record maintained by the court, clerk, recorder or Department of Revenue.

Copyright © 2002-2025 Doxpop, Ilc. All Rights Reserved

Search Results for:

LOT: 2
BLOCK: 4
SUBDIVISION: ORIGINAL PLAT RIDGEVILLE
REGION: Randolph County, IN
DOCUMENTS VALIDATED THROUGH: 08/4/2025 2:54 PM

Showing 11 results

Filter:

Document Details	County	Date	Type	Name	Legal
Book 233, Page 359	Randolph	06/28/1982	DEED : WARRANTY DEED	Search FRIEND, BERNARD LEE Search FRIEND, CAROLYN SUE Search MOCK, JOHN ROBERT Search MOCK, SHARON	Non-land Search Lot 2 Block 4 ORIGINAL PLAT RIDGEVILLE Search Lot 3 Block 4 ORIGINAL PLAT RIDGEVILLE Search Lot 6 Block 4 ORIGINAL PLAT RIDGEVILLE
Book 233, Page 360	Randolph	06/28/1982	DEED : WARRANTY DEED	Search MOCK, JOHN ROBERT Search MOCK, SHARON Search FRIONS, GARY DEAN	Search Lot 2 Block 4 ORIGINAL PLAT RIDGEVILLE Search Lot 3 Block 4 ORIGINAL PLAT RIDGEVILLE Search Lot 6 Block 4 ORIGINAL PLAT RIDGEVILLE
Book 241, Page 359	Randolph	12/02/1985	DEED : WARRANTY DEED	Search LAKES, LOIS ANN Search CHALFANT, CLAUDIA J	Search Lot 2 Block 4 ORIGINAL PLAT RIDGEVILLE Search Lot 3 Block 4 ORIGINAL PLAT RIDGEVILLE
Book 255, Page 449	Randolph	01/02/1991	DEED : WARRANTY DEED	Search CHALFANT, CLAUDIA J Search SIMS, TIMOTHY W	Search Lot 2 Block 4 ORIGINAL PLAT RIDGEVILLE Search Lot 3 Block 4 ORIGINAL PLAT RIDGEVILLE
20040677	Randolph	02/17/2004	DEED : WARRANTY DEED	Search HALE, CINDA K Search WYSONG, CINDA K Search WYSONG, KENNETH L Search DAVIS, JOHN M	Search Lot 2 Block 4 ORIGINAL PLAT RIDGEVILLE Search Lot 3 Block 4 ORIGINAL PLAT RIDGEVILLE Search Lot 6 Block 4 ORIGINAL PLAT RIDGEVILLE
20040992	Randolph	03/01/2004	MORT : MORTGAGE	Search DAVIS, JOHN M Search RANDOLPH COUNTY BANK NA	Search Lot 2 Block 4 ORIGINAL PLAT RIDGEVILLE Search Lot 3 Block 4 ORIGINAL PLAT RIDGEVILLE Search Lot 6 Block 4 ORIGINAL PLAT RIDGEVILLE

Document Details	County	Date	Type	Name	Legal
20061616	Randolph	03/23/2006	DEED : SHERIFFS DEED	Search THEURER, JOSEPH T Search FIRST NATIONAL BANK	Search Lot 2 Block 4 ORIGINAL PLAT RIDGEVILLE Search Lot 3 Block 4 ORIGINAL PLAT RIDGEVILLE
20063298	Randolph	07/06/2006	DEED : CORPORATE DEED	Search FIRST NATIONAL BANK Search BOWDELL, PAMELA S Search BOWDELL, WILLIAM H	Search Lot 2 Block 4 ORIGINAL PLAT RIDGEVILLE Search Lot 3 Block 4 ORIGINAL PLAT RIDGEVILLE
20076186	Randolph	12/20/2007	MISC : CONTRACT	Search DAVIS, JOHN M Search DAVIS, KARL E	Search Lot 2 Block 4 ORIGINAL PLAT RIDGEVILLE Search Lot 3 Block 4 ORIGINAL PLAT RIDGEVILLE Search Lot 6 Block 4 ORIGINAL PLAT RIDGEVILLE
20082157	Randolph	05/21/2008	DEED : WARRANTY DEED	Search BOWDELL, PAMELA S Search BOWDELL, WILLIAM H Search MOYER, KORI M Search MOYER, WILLIAM C	Search Lot 2 Block 4 ORIGINAL PLAT RIDGEVILLE Search Lot 3 Block 4 ORIGINAL PLAT RIDGEVILLE
20082158	Randolph	05/21/2008	MORT : MORTGAGE	Search MOYER, WILLIAM C Search JPMORGAN CHASE BANK NA	Search Lot 2 Block 4 ORIGINAL PLAT RIDGEVILLE Search Lot 3 Block 4 ORIGINAL PLAT RIDGEVILLE

The data or information provided is based on information obtained from Indiana Courts, Clerks, Recorders, and Department of Revenue, and is not to be considered or used as an official record. Doxpop, LLC, the Division of State Court Administration, the Indiana Courts and Clerks of Court, the Indiana Recorders, and the Indiana Department of Revenue: 1) Do not warrant that the information is accurate or complete; 2) Make no representations regarding the identity of any persons whose names appear in the information; and 3) Disclaim any liability for any damages resulting from the release or use of the information. The user should verify the information by personally consulting the official record maintained by the court, clerk, recorder or Department of Revenue.

Copyright © 2002-2025 Doxpop, llc. All Rights Reserved

Search Results for:

LOT: 3
BLOCK: 4
SUBDIVISION: ORIGINAL PLAT RIDGEVILLE
REGION: Randolph County, IN
DOCUMENTS VALIDATED THROUGH: 08/4/2025 2:54 PM

Showing 11 results

Filter:

Document Details	County	Date	Type	Name	Legal
Book 233, Page 359	Randolph	06/28/1982	DEED : WARRANTY DEED	Search FRIEND, BERNARD LEE Search FRIEND, CAROLYN SUE Search MOCK, JOHN ROBERT Search MOCK, SHARON	Non-land Search Lot 2 Block 4 ORIGINAL PLAT RIDGEVILLE Search Lot 3 Block 4 ORIGINAL PLAT RIDGEVILLE Search Lot 6 Block 4 ORIGINAL PLAT RIDGEVILLE
Book 233, Page 360	Randolph	06/28/1982	DEED : WARRANTY DEED	Search MOCK, JOHN ROBERT Search MOCK, SHARON Search FRIONS, GARY DEAN	Search Lot 2 Block 4 ORIGINAL PLAT RIDGEVILLE Search Lot 3 Block 4 ORIGINAL PLAT RIDGEVILLE Search Lot 6 Block 4 ORIGINAL PLAT RIDGEVILLE
Book 241, Page 359	Randolph	12/02/1985	DEED : WARRANTY DEED	Search LAKES, LOIS ANN Search CHALFANT, CLAUDIA J	Search Lot 2 Block 4 ORIGINAL PLAT RIDGEVILLE Search Lot 3 Block 4 ORIGINAL PLAT RIDGEVILLE
Book 255, Page 449	Randolph	01/02/1991	DEED : WARRANTY DEED	Search CHALFANT, CLAUDIA J Search SIMS, TIMOTHY W	Search Lot 2 Block 4 ORIGINAL PLAT RIDGEVILLE Search Lot 3 Block 4 ORIGINAL PLAT RIDGEVILLE
20040677	Randolph	02/17/2004	DEED : WARRANTY DEED	Search HALE, CINDA K Search WYSONG, CINDA K Search WYSONG, KENNETH L Search DAVIS, JOHN M	Search Lot 2 Block 4 ORIGINAL PLAT RIDGEVILLE Search Lot 3 Block 4 ORIGINAL PLAT RIDGEVILLE Search Lot 6 Block 4 ORIGINAL PLAT RIDGEVILLE
20040992	Randolph	03/01/2004	MORT : MORTGAGE	Search DAVIS, JOHN M Search RANDOLPH COUNTY BANK NA	Search Lot 2 Block 4 ORIGINAL PLAT RIDGEVILLE Search Lot 3 Block 4 ORIGINAL PLAT RIDGEVILLE Search Lot 6 Block 4 ORIGINAL PLAT RIDGEVILLE

Document Details	County	Date	Type	Name	Legal
20061616	Randolph	03/23/2006	DEED : SHERIFFS DEED	Search THEURER, JOSEPH T Search FIRST NATIONAL BANK	Search Lot 2 Block 4 ORIGINAL PLAT RIDGEVILLE Search Lot 3 Block 4 ORIGINAL PLAT RIDGEVILLE
20063298	Randolph	07/06/2006	DEED : CORPORATE DEED	Search FIRST NATIONAL BANK Search BOWDELL, PAMELA S Search BOWDELL, WILLIAM H	Search Lot 2 Block 4 ORIGINAL PLAT RIDGEVILLE Search Lot 3 Block 4 ORIGINAL PLAT RIDGEVILLE
20076186	Randolph	12/20/2007	MISC : CONTRACT	Search DAVIS, JOHN M Search DAVIS, KARL E	Search Lot 2 Block 4 ORIGINAL PLAT RIDGEVILLE Search Lot 3 Block 4 ORIGINAL PLAT RIDGEVILLE Search Lot 6 Block 4 ORIGINAL PLAT RIDGEVILLE
20082157	Randolph	05/21/2008	DEED : WARRANTY DEED	Search BOWDELL, PAMELA S Search BOWDELL, WILLIAM H Search MOYER, KORI M Search MOYER, WILLIAM C	Search Lot 2 Block 4 ORIGINAL PLAT RIDGEVILLE Search Lot 3 Block 4 ORIGINAL PLAT RIDGEVILLE
20082158	Randolph	05/21/2008	MORT : MORTGAGE	Search MOYER, WILLIAM C Search JPMORGAN CHASE BANK NA	Search Lot 2 Block 4 ORIGINAL PLAT RIDGEVILLE Search Lot 3 Block 4 ORIGINAL PLAT RIDGEVILLE

The data or information provided is based on information obtained from Indiana Courts, Clerks, Recorders, and Department of Revenue, and is not to be considered or used as an official record. Doxpop, LLC, the Division of State Court Administration, the Indiana Courts and Clerks of Court, the Indiana Recorders, and the Indiana Department of Revenue: 1) Do not warrant that the information is accurate or complete; 2) Make no representations regarding the identity of any persons whose names appear in the information; and 3) Disclaim any liability for any damages resulting from the release or use of the information. The user should verify the information by personally consulting the official record maintained by the court, clerk, recorder or Department of Revenue.

Copyright © 2002-2025 Doxpop, llc. All Rights Reserved